



City of Westminster

Licensing Sub-Committee Report

Item No:

Date:

Licensing Ref No:

Title of Report:

Report of:

Wards involved:

Policy context:

Financial summary:

Report Author:

Contact details

16 March 2023

23/00332/LIPV - Premises Licence Variation

Lio London
Basement And Lower Ground Floor
3-4 Coventry Street
London
W1D 6BL

Director of Public Protection and Licensing

St James's

City of Westminster Statement of Licensing Policy

None

Kevin Jackaman
Senior Licensing Officer

Telephone: 0207 641 6500
Email: kjackaman@westminster.gov.uk

1.	Application		
1-A	Applicant and premises		
Application Type:	Variation of a Premises Licence, Licensing Act 2003		
Application received date:	19 January 2023		
Applicant:	Lio London Ltd		
Premises:	Lio London		
Premises address:	Basement And Lower Ground Floor 3-4 Coventry Street London W1D 6BL	Ward:	St James's
		Cumulative Impact Area:	West End
		Special Consideration Zone:	None
Premises description:	The premise are a performance venue and night club featuring singers, dancers, acrobats and international artists.		
Variation description:	To vary the existing premises licence so as to: 1) Remove conditions 9, 18 and 26 and add further model conditions as set out in section 1D. 2) Extend the terminal hour for sales of alcohol by one hour to 04:00 Monday to Saturday and Sundays before Bank Holidays (only). No Change Sundays; and 3) To include the provision of films Monday to Saturday 10:00 to 04:00 and Sunday 12:00 to 00:30, in accordance with the proposed hours for sales of alcohol.		
Premises licence history:	<p>The premises have had the benefit of a premises licence since at least 2005. The current premises licence reference is 23/00905/LIPVM, a copy of which is attached as Appendix 2 of this report.</p> <p>Please see Appendix 4 of the report for a full licence history</p> <p>The premises also has the benefit of a "shadow licence" (Licence number 20/11986/LIPN)</p>		
Applicant submissions:	The applicant has proposed a schedule of model conditions to be added to the premises licence. The conditions are set out at section 1D		
Applicant amendments:	Since submission of this application, the applicant has removed condition 26 by way of a minor variation application and consequently is no longer seeking to remove this condition as part of the current application.		

1-B	Current licensable activities, areas and hours					
Regulated Entertainment						
Performance of Dance						
	Current Hours		Proposed Hours		Licensable Area	
	Start:	End:	Start:	End:	Current:	Proposed:
Monday	09:00	06:00	No change		Basement and lower ground floor	No change
Tuesday	09:00	06:00				
Wednesday	09:00	06:00				
Thursday	09:00	06:00				
Friday	09:00	06:00				
Saturday	09:00	06:00				
Sunday	09:00	06:00				
Seasonal Variations/ Non-standard timings:	Current:				Proposed:	
	None				No change	

Performance of Live Music						
	Current Hours		Proposed Hours		Licensable Area	
	Start:	End:	Start:	End:	Current:	Proposed:
Monday	09:00	06:00	No change		Basement and lower ground floor	No change
Tuesday	09:00	06:00				
Wednesday	09:00	06:00				
Thursday	09:00	06:00				
Friday	09:00	06:00				
Saturday	09:00	06:00				
Sunday	09:00	06:00				
Seasonal Variations/ Non-standard timings:	Current:				Proposed:	
	None				No change	

Recorded music						
	Current Hours		Proposed Hours		Licensable Area	
	Start:	End:	Start:	End:	Current:	Proposed:
Monday	Unrestricted		No change		Basement and lower ground floor	No change
Tuesday						
Wednesday						
Thursday						
Friday						
Saturday						
Sunday						
Seasonal Variations/ Non-standard timings:	Current:				Proposed:	
	None				No change	

Anything of a similar description to live music, recorded music or performance of dance						
	Current Hours		Proposed Hours		Licensable Area	
	Start:	End:	Start:	End:	Current:	Proposed:
Monday	09:00	06:00	No change		Basement and lower ground floor	No change
Tuesday	09:00	06:00				
Wednesday	09:00	06:00				
Thursday	09:00	06:00				
Friday	09:00	06:00				
Saturday	09:00	06:00				
Sunday	09:00	06:00				
Seasonal Variations/ Non-standard timings:	Current: None				Proposed: No change	

Private Entertainment consisting of dancing, music or other entertainment of a like kind for consideration and with a view to profit						
	Current Hours		Proposed Hours		Licensable Area	
	Start:	End:	Start:	End:	Current:	Proposed:
Monday	09:00	06:00	No change		Basement and lower ground floor	No change
Tuesday	09:00	06:00				
Wednesday	09:00	06:00				
Thursday	09:00	06:00				
Friday	09:00	06:00				
Saturday	09:00	06:00				
Sunday	09:00	06:00				
Seasonal Variations/ Non-standard timings:	Current: None				Proposed: No change	

Late night refreshment						
Indoors, outdoors or both			Current :		Proposed:	
			Both		No change	
	Current Hours		Proposed Hours		Licensable Area	
	Start:	End:	Start:	End:	Current:	Proposed:
Monday	23:00	06:00	No change		Basement and lower ground floor	No change
Tuesday	23:00	06:00				
Wednesday	23:00	06:00				
Thursday	23:00	06:00				
Friday	23:00	06:00				
Saturday	23:00	06:00				
Sunday	23:00	06:00				
Seasonal variations/ Non-standard timings:	Current: The terminal hour for late night refreshment on New Year's Eve is extended to 05:00 on New Year's Day.				Proposed: No change	

Sale by Retail of Alcohol						
On or off sales			Current :		Proposed:	
			On and off		No change	
	Current Hours		Proposed Hours		Licensable Area	
	Start:	End:	Start:	End:	Current:	Proposed:
Monday	10:00	03:00	10:00	04:00	Basement and lower ground floor	No change
Tuesday	10:00	03:00	10:00	04:00		
Wednesday	10:00	03:00	10:00	04:00		
Thursday	10:00	03:00	10:00	04:00		
Friday	10:00	03:00	10:00	04:00		
Saturday	10:00	03:00	10:00	04:00		
Sunday	12:00	00:30	No change			
Seasonal variations/ Non-standard timings:	Current: Sundays before Bank Holidays (other than Easter Sunday) 12:00 to 03:00 The permitted hours on New Year's Eve will extend to the start of permitted hours on the following day, or if there are no permitted hours on 1 January, to 00.00 on New Year's Eve.				Proposed: Sundays before Bank Holidays 12:00 to 04:00 The permitted hours on New Year's Eve will extend to the start of permitted hours on the following day, or if there are no permitted hours on 1 January, to 00.00 on New Year's Eve.	

Hours premises are open to the public						
	Current Hours		Proposed Hours		Premises Area	
	Start:	End:	Start:	End:	Current:	Proposed:
Monday	09:00	06:00	No change		Basement and lower ground floor	No change
Tuesday	09:00	06:00				
Wednesday	09:00	06:00				
Thursday	09:00	06:00				
Friday	09:00	06:00				
Saturday	09:00	06:00				
Sunday	09:00	06:00				
Seasonal variations/ Non-standard timings:	Current: None				Proposed: No change	

1-B	Licensable activities to be added					
Films						
Indoors, outdoors or both			Current :		Proposed:	
			N/A		Indoors	
	Current Hours		Proposed Hours		Licensable Area	
	Start:	End:	Start:	End:	Current:	Proposed:
Monday	NA		10:00	04:00	Basement and lower ground floor	No change
Tuesday			10:00	04:00		
Wednesday			10:00	04:00		
Thursday			10:00	04:00		
Friday			10:00	04:00		
Saturday			10:00	04:00		
Sunday			12:00	00:30		
Seasonal variations/ Non-standard timings:		Current:			Proposed:	
		N/A			Sundays before Bank Holidays 12:00 to 04:00 The permitted hours on New Year's Eve will extend to the start of permitted hours on the following day, or if there are no permitted hours on 1 January, to 00.00 on New Year's Eve.	

1-C	Layout alteration
No alteration of layout is proposed	

1-D	Conditions being removed
<p>9. This licence is subject to all the former Rules of Management for Places of Public Entertainment licensed by Westminster City Council, in force from 4 September 1998 and incorporating amendments agreed by the Council on 25 October 1999, 30 June 2000, 16 January 2001 and 1 October 2001.</p> <p>18. A Close Circuit Television system shall be installed, maintained and operated correctly as specified by a Metropolitan Police Crime Prevention Officer. The tapes from the system to be retained for a period of 28 days.</p> <p>26. After 23:00 on Friday and Saturday night where the premises operate as a nightclub or an external promoter led event all drinking vessels used in the venue shall be Polycarbonate. All drinks in glass bottles are to be decanted into polycarbonate containers or polycarbonate carafes prior to being served, with the exception of champagne or bottles of spirits with a minimum size of 70cl supplied by waiter/waitress service to tables. Staff shall clear all empty champagne and spirit bottles promptly from the tables. Customers shall not be permitted to leave their table carrying any such glass bottles or drink directly from the bottle.</p> <p>Since submission, condition 26 has been removed by way of a minor variation application.</p>	

1-D	Conditions being added
<p>Condition</p> <ul style="list-style-type: none"> • The premises shall install and maintain a comprehensive CCTV system as per the minimum requirements of the Westminster Police Licensing Team. <ul style="list-style-type: none"> (b) All entry and exit points will be covered enabling frontal identification of every person entering in any light condition. (c) The CCTV system shall continually record whilst the premises is open for licensable activities and during all times when customers remain on the premises and will include the external area immediately outside the premises entrance. (d) All recordings shall be stored for a minimum period of 31 days with date and time stamping. (e) Viewing of recordings shall be made available immediately upon the request of Police or authorised officer throughout the entire 31-day period. • A staff member from the premises who is conversant with the operation of the CCTV system shall be on the premises at all times when the premises is open. This staff member must be able to provide a Police or authorised council officer copies of recent CCTV images or data with the absolute minimum of delay when requested. • An incident log shall be kept at the premises, and made available on request to an authorised officer of the City Council or the Police. It must be completed within 24 hours of the incident and will record the following: <ul style="list-style-type: none"> (a) all crimes reported to the venue (b) all ejections of patrons (c) any complaints received concerning crime and disorder (d) any incidents of disorder (e) all seizures of drugs or offensive weapons (f) any faults in the CCTV system, searching equipment or scanning equipment (g) any refusal of the sale of alcohol (h) any visit by a relevant authority or emergency service. 	

- A copy of the premises' dispersal policy shall be made readily available at the premises for inspection by a police officer and/or an authorised officer of Westminster City Council.
- A Challenge 25 proof of age scheme shall be operated at the premises where the only acceptable forms of identification are recognised photographic identification cards, such as a driving licence, passport or proof of age card with the PASS Hologram.
- The approved arrangements at the premises, including means of escape provisions, emergency warning equipment, the electrical installation and mechanical equipment, shall at all material times be maintained in good condition and full working order.
- The means of escape provided for the premises shall be maintained unobstructed, free of trip hazards, be immediately available and clearly identified in accordance with the plans provided.
- All emergency exit doors shall be available at all material times without the use of a key, code, card or similar means.
- All emergency doors shall be maintained effectively self closing and not held open other than by an approved device.
- The edges of the treads of steps and stairways shall be maintained so as to be conspicuous.
- Curtains and hangings shall be arranged so as not to obstruct emergency safety signs or emergency equipment.
- After 03:00, Patrons permitted to temporarily leave and then re-enter the premises, e.g. to smoke or make a phone call, shall be limited to (TBC) persons at any one time.
- Patrons permitted to temporarily leave and then re-enter the premises, e.g. to smoke or make a phone call, shall not be permitted to take glass containers with them.
- The premises licence holder shall ensure that any patrons smoking outside the premises do so in an orderly manner and are properly supervised by staff so as to ensure that there is no public nuisance or obstruction of the public highway.
- There shall be no new admittance to the premises after 03:00 hours.
- All members of management will be provided with Welfare and Vulnerability Engagement (WAVE) training to provide those working in the licensed industry with an awareness of vulnerability and their responsibilities towards people visiting their premises. This training is available at: [Welfare and Vulnerability Engagement \(WAVE\) Resources \(nbcc.police.uk\)](http://nbcc.police.uk)

Adult entertainment:	Current position:	Proposed position:
	None	No change

2.	Representations
2-A	Responsible Authorities
Responsible Authority:	Metropolitan Police Service
Representative:	Reaz Guerra
Received:	15 February 2023
<p>With reference to the above applications, I am writing to inform you that the Metropolitan Police, as a Responsible Authority, are objecting to this application as it is our belief that if granted the application would undermine the Licensing Objectives. The premises are situated within the West End Cumulative Impact Area.</p> <p>There is insufficient detail contained within the operating schedule to promote the licensing objectives.</p> <p>The hours sought exceed Westminster's Core Hours Policy.</p> <p>It is for these reasons that we object to this application.</p>	

Responsible Authority:	Environmental Health
Representative:	Sally Fabbricatore
Received:	10 February 2023
<p>I refer to the variation Premises Licence for the above premises. The premises already benefits from a premises licence 22/08698/LIPVM.</p> <p>The premises is situated in the West End Cumulative Impact Zone.</p> <p>This representation is based on the Operating Schedule, no further layout plans have been submitted.</p> <p>The applicant is seeking the following:</p> <ol style="list-style-type: none"> 1. To extend the terminal hour for the Supply of Alcohol (both on and off the premises) on Monday to Saturday and Sundays prior to bank holidays to 04:00 hours. 2. To include the provision of Films Monday to Saturday 10:00-04:00 hours, Sunday 12:00-00:30 hours and Sundays prior to bank holidays 12:00-04:00 hours. 3. To remove and replace conditions. <p>I wish to make the following representation in relation to the above application:</p> <ol style="list-style-type: none"> 1. The extension of hours for Late Night Refreshment may cause an increase in Public Nuisance in the cumulative impact zone. 2. The provision of Films may cause an increase in Public Nuisance in the cumulative impact zone and may impact on Public Safety. 3. The removal and replacement of conditions may cause an increase in Public Nuisance in the cumulative impact zone. <p>The premises has undertaken pre-application advice 22/09691/PREAPM, where the issues and conditions raised have been taken into account, this is all being considered, but further</p>	

conditions may be proposed by Environmental Health in order to protect the Licensing Objectives.

The granting of the variation Premises Licence as presented would have the likely effect of causing an increase in Public Nuisance in the cumulative impact zone.

Responsible Authority:	Licensing Authority
Representative:	Jessica Donovan
Received:	15 February 2023

Dear Sirs

I write in relation to the application submitted for a variation of the premises licence for Lio London, Basement And Lower Ground Floor, 3-4 Coventry Street, London, W1D 6BL.

As a responsible authority under section 13 (4) of the Licensing Act 2003 as amended under the Police and Social Responsibility Act 2011, the Licensing Authority have considered your application in full. The Licensing Authority has concerns in relation to this application and how the premises would promote the four Licensing Objectives:

- Public Nuisance
- Prevention of Crime & Disorder
- Public Safety
- Protection of children from harm

The application seeks the following variations:

- To remove and/or replace the conditions as outlined in the appended schedule of conditions;
- To extend the terminal hour for sales of alcohol by one hour to 04:00 Monday to Saturday and Sundays before Bank Holidays (only). No change Sundays; and
- To include the provision of films Monday to Saturday 10:00 to 04:00 and Sunday 12:00 to 00:30, in accordance with the proposed hours for sales of alcohol.

The premises are located within the West End Cumulative Impact Zone and it is noted that the existing premises conditions contains a condition that states “The sale of alcohol must be ancillary to the use of the premises for music and dancing and substantial refreshment” and as such various policy points must be considered, namely MD1, HRS1 and CIP1.

Policy MD1 (B) states:

B. It is the Licensing Authority’s policy to refuse applications within the West End Cumulative Impact Zone other than:

1. Applications to vary the existing licence hours within the council’s Core Hours Policy HRS1, and/or,
2. Applications that seek to vary the existing licence so as to reduce the overall capacity of the premises.

C. The applications referred to in Clause B1 and B2 will generally be granted subject to:

1. The application meeting the requirements of policies CD1, PS1, PN1 and CH1.
2. The operation of any delivery services for alcohol and/or late night refreshment meeting the Council’s Ancillary Delivery of Alcohol and/or Late-Night Refreshment Policy DEL1.

3. The application and operation of the venue continuing to meet the definition of a music and dance premises in Clause D.

D. For the purposes of this policy a music and dance premises is defined as a premises whereby the primary purpose of the venue is to:

1. Provide regulated entertainment in the form of music, either in the form of live performances or recorded, to customers.
2. Provide regulated entertainment in the form of music, either as live performances or recorded, and provide facilities for the provision of dance.
3. The sale by retail of alcohol may be provided as either a considerable element of the operation of the premises or ancillary to the provision of regulated entertainment. a. Examples of venues that would fall within this policy are night clubs or bars that provide music and dancing. b. De-regulated entertainment (as set out in the glossary will not be subject to this policy).

Policy CIP1 states:

A. It is the Licensing Authority's policy to refuse applications within the West End Cumulative Impact Zone for: pubs and bars, fast food premises, and music and dancing and similar entertainment, other than applications to:

1. Vary the hours within Core Hours under Policy HRS1, and/or
2. Vary the licence to reduce the overall capacity of the premises.

C. Applications for other premises types within the West End Cumulative Impact Zones will be subject to other policies within this statement and must demonstrate that they will not add to cumulative impact.

D. For the purposes of this policy the premises types referred to in Clause A are defined within the relevant premises use policies within this statement.

It is noted that proposed hours for licensable activities fall outside of Westminster's core hours for music and dance venues and therefore are a contrary to policy.

The Core hours for music and dance venues are:

Monday to Thursday: 10am to 11.30pm.

Friday and Saturday: 10am to Midnight.

Sunday: Midday to 10.30pm.

Sundays immediately prior to a bank holiday: Midday to Midnight.

Given that the hours applied for are in excess of Westminster's core hours, the Licensing Authority require the applicant to provide submissions as to how the operation of the premises will not add to cumulative impact in the West End cumulative impact zone, in accordance with policy CIP1.

The Licensing Authority looks forward to receiving further submissions from the applicant in due course.

Please accept this as a formal representation.

3. Policy & Guidance

The following policies within the City of Westminster Statement of Licensing Policy apply:	
Policy CIP1 applies	<p>A. It is the Licensing Authority’s policy to refuse applications within the West End Cumulative Impact Zone for: pubs and bars, fast food premises, and music and dancing and similar entertainment, other than applications to:</p> <ol style="list-style-type: none"> 1. Vary the hours within Core Hours under Policy HRS1, and/or 2. Vary the licence to reduce the overall capacity of the premises. <p>C. Applications for other premises types within the West End Cumulative Impact Zones will be subject to other policies within this statement and must demonstrate that they will not add to cumulative impact.</p> <p>D. For the purposes of this policy the premises types referred to in Clause A are defined within the relevant premises use policies within this statement.</p>
Policy HRS1 applies	<p>A. Applications within the core hours set out below in this policy will generally be granted for the relevant premises uses, subject to not being contrary to other policies in the Statement of Licensing Policy.</p> <p>B. Applications for hours outside the core hours set out in Clause C will be considered on their merits, subject to other relevant policies, and with particular regard to the following:</p> <ol style="list-style-type: none"> 1. The demonstration of compliance in the requirements of policies CD1, PS1, PN1 and CH1 associated with the likelihood of the effect of the grant of a licence for later or earlier hours on crime and disorder, public safety, public nuisance and the protection of children from harm. 2. If the application is located within a Special Consideration Zone they have demonstrated that they have taken account of the issues identified in that area and provided adequate mitigation. 3. Whether there is residential accommodation in the proximity of the premises that would likely be adversely affected by premises being open or carrying out operations at the hours proposed. 4. The proposed hours of the licensable activities and when customers will be permitted to remain on the premises. 5. The proposed hours when any music, including incidental music, will be played. 6. The hours when customers will be allowed to take food or drink outside the premises or be within open areas which form part of the premises. 7. The existing hours of licensable activities and the past operation of the premises (if any) and hours of licensable premises in the vicinity. 8. Whether customers and staff have adequate access to public transport when arriving at and leaving the premises, especially at night. 9. The capacity of the premises. 10. The type of use, recognising that some venues are more likely to impact the licensing objectives than others; for example, pubs and bars are higher risk than theatres, cinemas and other cultural and sporting venues due to the nature of the operation. 11. The Licensing Authority will take into account the active measures proposed for a ‘winding down’ period including arrangements for people to be collected from the premises to travel

	<p>home safely.</p> <p>12. Conditions on hours may be attached that require that the supply of alcohol for consumption on the premises ceases a suitable period of time before customers are required to leave the premises.</p> <p>13. The council, acting as the Licensing Authority, may reduce hours if, after review, it is necessary to impose conditions specifying shorter hours in order to promote the licensing objectives.</p> <p>14. Specific days for non-standard hours should be identified and justified as part of the application to allow responsible authorities and interested parties to evaluate the impact that these licensable activities may have, and to plan accordingly. The consideration of applications for later hours for Bank Holiday Mondays will take into account that later hours are generally granted for preceding Sundays and that the next day is a working day. Non-specific days are expected to be covered by Temporary Event Notices or variation applications.</p>
<p>Policy MD1(B) applies</p>	<p>B. It is the Licensing Authority's policy to refuse applications within the West End Cumulative Impact Zone other than:</p> <ol style="list-style-type: none"> 1. Applications to vary the existing licence hours within the council's Core Hours Policy HRS1, and/or, 2. Applications that seek to vary the existing licence so as to reduce the overall capacity of the premises. <p>C. The applications referred to in Clause B1 and B2 will generally be granted subject to:</p> <ol style="list-style-type: none"> 1. The application meeting the requirements of policies CD1, PS1, PN1 and CH1. 2. The operation of any delivery services for alcohol and/or latenight refreshment meeting the Council's Ancillary Delivery of Alcohol and/or Late-Night Refreshment Policy DEL1. 3. The application and operation of the venue continuing to meet the definition of a music and dance premises in Clause D. <p>D. For the purposes of this policy a music and dance premises is defined as a premises whereby the primary purpose of the venue is to:</p> <ol style="list-style-type: none"> 1. Provide regulated entertainment in the form of music, either in the form of live performances or recorded, to customers. 2. Provide regulated entertainment in the form of music, either as live performances or recorded, and provide facilities for the provision of dance. 3. The sale by retail of alcohol may be provided as either a considerable element of the operation of the premises or ancillary to the provision of regulated entertainment. <ol style="list-style-type: none"> a. Examples of venues that would fall within this policy are night clubs or bars that provide music and dancing. b. De-regulated entertainment (as set out in the glossary will not be subject to this policy).

4. Equality Implications

The Council in its capacity as Licensing Authority has a duty to have regard to its public sector equality duty under section 149 of the Equality Act 2010. In summary, section 149 provides that a Public Authority must, in the exercise of its functions, have due regard to the need to:

- (a) eliminate discrimination harassment, victimisation and any other conduct that is prohibited by or under this Act;
- (b) advance equality of opportunity between persons who share a relevant protected characteristic and persons who do not share it; and
- (c) foster good relations between persons who share a relevant protected characteristics and persons who do not share it.

Section 149 (7) of the Equality Act 2010 defines the relevant protected characteristics as age, disability, gender reassignment, marriage and civil partnership, pregnancy and maternity, race, religion or belief, sex, and sexual orientation.

5.	Appendices
Appendix 1	Premises plans
Appendix 2	Applicant supporting documents
Appendix 3	Premises history
Appendix 4	Proposed conditions
Appendix 5	Residential map and list of premises in the vicinity

Report author:	Kevin Jackaman Senior Licensing Officer
Contact:	Telephone: 02087 641 6500 Email: kjackaman@westminster.gov.uk

If you have any queries about this report or wish to inspect one of the background papers please contact the report author.

Background Documents – Local Government (Access to Information) Act 1972

1	Licensing Act 2003	N/A
2	City of Westminster Statement of Licensing Policy	October 2021
3	Amended Guidance issued under section 182 of the Licensing Act 2003	December 2022
4	Metropolitan Police Service representation	15 February 2023
5	Environmental Health representation	10 February 2023
6	Licensing Authority representation	15 February 2023



City of Westminster

64 Victoria Street, London, SW1E 6QP

Schedule 12
Part A

WARD: St James's
UPRN: 010033579206

Premises licence

Regulation 33, 34

Premises licence number:

23/00905/LIPVM

Original Reference:

05/06541/LIPCV

Part 1 – Premises details

Postal address of premises:

Lio London
Basement and Lower Ground Floor
3-4 Coventry Street
London
W1D 6BL

Telephone Number: 0207 734 7700

Where the licence is time limited, the dates:

Not applicable

Licensable activities authorised by the licence:

Performance of Dance
Performance of Live Music
Playing of Recorded Music
Anything of a similar description to Live Music, Recorded Music or Performance of Dance
Late Night Refreshment
Private Entertainment consisting of dancing, music or other entertainment of a like kind for consideration and with a view to profit
Sale by Retail of Alcohol

The times the licence authorises the carrying out of licensable activities:

Performance of Dance

Monday to Sunday: 09:00 to 06:00

Performance of Live Music

Monday to Sunday: 09:00 to 06:00

Playing of Recorded Music

Unrestricted

Anything of a similar description to Live Music, Recorded Music or Performance of Dance

Monday to Sunday: 09:00 to 06:00

Late Night Refreshment

Monday to Sunday: 23:00 to 06:00

Private Entertainment consisting of dancing, music or other entertainment of a like kind for consideration and with a view to profit Unrestricted

Sale by Retail of Alcohol

Monday to Saturday: 10:00 to 03:00
Sunday: 12:00 to 00:30
Sundays before Bank Holidays: 12:00 to 03:00 (Other than Easter Sunday)

For times authorised for New Year see conditions at Annex 1

The opening hours of the premises:

Monday to Sunday: 09:00 to 06:00

Where the licence authorises supplies of alcohol, whether these are on and/or off supplies:

Alcohol is supplied for consumption both on and off the Premises.

Part 2**Name, (registered) address, telephone number and email (where relevant) of holder of premises licence:**

Lio London Ltd
The Courtyard
14A Sydenham Road
Croydon
CR0 2EE

Registered number of holder, for example company number, charity number (where applicable)

11551613

Name, address and telephone number of designated premises supervisor where the premises licence authorises the supply of alcohol:

Name: Aaron Sinkia

Please note: It is the policy of the Licensing Authority not to display the address details of a designated premises supervisor.

Personal licence number and issuing authority of personal licence held by designated premises supervisor where the premises licence authorises for the supply of alcohol:

Licence Number: 847543
Licensing Authority: London Borough of Southwark

Date: 07 March 2023

This licence has been authorised by Emanuela Meloyan on behalf of the Director - Public Protection and Licensing.

Annex 1 – Mandatory conditions

1. No supply of alcohol may be made at a time when there is no designated premises supervisor in respect of this licence.
2. No supply of alcohol may be made at a time when the designated premises supervisor does not hold a personal licence or the personal licence is suspended.
3. Every supply of alcohol under this licence must be made or authorised by a person who holds a personal licence.
4.
 - (1) The responsible person must ensure that staff on relevant premises do not carry out, arrange or participate in any irresponsible promotions in relation to the premises.
 - (2) In this paragraph, an irresponsible promotion means any one or more of the following activities, or substantially similar activities, carried on for the purpose of encouraging the sale or supply of alcohol for consumption on the premises—
 - (a) games or other activities which require or encourage, or are designed to require or encourage, individuals to:
 - (i) drink a quantity of alcohol within a time limit (other than to drink alcohol sold or supplied on the premises before the cessation of the period in which the responsible person is authorised to sell or supply alcohol), or
 - (ii) drink as much alcohol as possible (whether within a time limit or otherwise);
 - (b) provision of unlimited or unspecified quantities of alcohol free or for a fixed or discounted fee to the public or to a group defined by a particular characteristic in a manner which carries a significant risk of undermining a licensing objective;
 - (c) provision of free or discounted alcohol or any other thing as a prize to encourage or reward the purchase and consumption of alcohol over a period of 24 hours or less in a manner which carries a significant risk of undermining a licensing objective;
 - (d) selling or supplying alcohol in association with promotional posters or flyers on, or in the vicinity of, the premises which can reasonably be considered to condone, encourage or glamorise anti-social behaviour or to refer to the effects of drunkenness in any favourable manner;
 - (e) dispensing alcohol directly by one person into the mouth of another (other than where that other person is unable to drink without assistance by reason of a disability).
5. The responsible person must ensure that free potable water is provided on request to customers where it is reasonably available.
6.
 - (1) The premises licence holder or club premises certificate holder must ensure that an age verification policy is adopted in respect of the premises in relation to the sale or supply of alcohol.
 - (2) The designated premises supervisor in relation to the premises licence must ensure that the supply of alcohol at the premises is carried on in accordance with the age verification policy.
 - (3) The policy must require individuals who appear to the responsible person to be under 18 years of age (or such older age as may be specified in the policy) to produce on request, before being served alcohol, identification bearing their photograph, date of birth and either—

- (a) a holographic mark, or
- (b) an ultraviolet feature.

7. The responsible person must ensure that—

- (a) where any of the following alcoholic drinks is sold or supplied for consumption on the premises (other than alcoholic drinks sold or supplied having been made up in advance ready for sale or supply in a securely closed container) it is available to customers in the following measures—
 - (i) beer or cider: ½ pint;
 - (ii) gin, rum, vodka or whisky: 25 ml or 35 ml; and
 - (iii) still wine in a glass: 125 ml;
- (b) these measures are displayed in a menu, price list or other printed material which is available to customers on the premises; and
- (c) where a customer does not in relation to a sale of alcohol specify the quantity of alcohol to be sold, the customer is made aware that these measures are available.

A responsible person in relation to a licensed premises means the holder of the premise licence in respect of the premises, the designated premises supervisor (if any) or any individual aged 18 or over who is authorised by either the licence holder or designated premises supervisor. For premises with a club premises certificate, any member or officer of the club present on the premises in a capacity that which enables him to prevent the supply of alcohol.

8. (i) A relevant person shall ensure that no alcohol is sold or supplied for consumption on or off the premises for a price which is less than the permitted price.
- (ii) For the purposes of the condition set out in paragraph 8(i) above -
- (a) "duty" is to be construed in accordance with the Alcoholic Liquor Duties Act 1979;
 - (b) "permitted price" is the price found by applying the formula -
$$P = D + (D \times V)$$

Where -

 - (i) P is the permitted price,
 - (ii) D is the amount of duty chargeable in relation to the alcohol as if the duty were charged on the date of the sale or supply of the alcohol, and
 - (iii) V is the rate of value added tax chargeable in relation to the alcohol as if the value added tax were charged on the date of the sale or supply of the alcohol;
 - (c) "relevant person" means, in relation to premises in respect of which there is in force a premises licence -
 - (i) the holder of the premises licence,
 - (ii) the designated premises supervisor (if any) in respect of such a licence, or
 - (iii) the personal licence holder who makes or authorises a supply of alcohol under such a licence;
 - (d) "relevant person" means, in relation to premises in respect of which there is in force a club premises certificate, any member or officer of the club present on the premises in a capacity which enables the member or officer to prevent the supply in question; and

- (e) "value added tax" means value added tax charged in accordance with the Value Added Tax Act 1994.
- (iii) Where the permitted price given by Paragraph 8(ii)(b) above would (apart from this paragraph) not be a whole number of pennies, the price given by that sub-paragraph shall be taken to be the price actually given by that sub-paragraph rounded up to the nearest penny.
- (iv) (1) Sub-paragraph 8(iv)(2) below applies where the permitted price given by Paragraph 8(ii)(b) above on a day ("the first day") would be different from the permitted price on the next day ("the second day") as a result of a change to the rate of duty or value added tax.

(2) The permitted price which would apply on the first day applies to sales or supplies of alcohol which take place before the expiry of the period of 14 days beginning on the second day.

Conditions reproducing the effect of conditions subject to which the relevant existing licences have effect.

Conditions relating to regulated entertainment:

- 9. This licence is subject to all the former Rules of Management for Places of Public Entertainment licensed by Westminster City Council, in force from 4 September 1998 and incorporating amendments agreed by the Council on 25 October 1999, 30 June 2000, 16 January 2001 and 1 October 2001.
- 10. Notwithstanding the provisions of Rule of Management No. 6 the premises may remain open for the purposes of this licence from 23:00 on each of the days Sunday to Saturday to 06:00 on the day following.
- 11. On New Year's Eve the premises can remain open for the purpose of providing regulated entertainment from the time when the provision of regulated entertainment must otherwise cease on New Year's Eve to the time when regulated entertainment can commence on New Year's Day (or until midnight on New Year's Eve where no regulated entertainment takes place on New Year's Day).
- 12. An attendant shall be stationed in the vicinity of the cloakroom during the whole time that it is in use.
- 13. Seven days notice shall be given to the Council when a live band is booked for which the primary purpose is NOT to provide music for dancing.
- 14. The number of persons accommodated (excluding staff) shall not exceed: Balcony - 150, Basement - 565.

Conditions for Sale of Alcohol

- 15. Substantial food and suitable beverages other than intoxicating liquor (including drinking water) shall be available during the whole of the permitted hours in all parts of the premises where intoxicating liquor is sold or supplied.
- 16. On any evening where the premises or part of the premises are open for music, dancing or entertainment and a Section 77 Special Hours Certificate is in operation, intoxicating liquor may not be sold or supplied to persons admitted to the premises after 11pm other than to:
 - a) Persons who have paid a minimum admission fee of at least £5 Monday to Thursday, and £7 Friday and Saturday (these fees to be reviewed and set by the Licensing Justices at their triennial renewal sessions) for music, dancing and entertainment (not to be credited against consumables); OR

- b) Persons who have paid a minimum annual admission fee of at least £150 payable in advance for music, dancing and entertainment (not to be credited against consumables). Such person may bring with them up to 4 guests. A list of all persons who have paid an annual admission fee will be held at reception for inspection by the relevant authority; OR
 - c) Any person attending a private function at the premises, details of the type of function, host and a list of persons attending having been provided to the police at least 24 hours previously; OR
 - d) Artistes and persons employed on the premises; OR e) Bona fide guests of the proprietor (not exceeding 10% of the total capacity for the premises as specified in the Public Entertainment Licence for the premises), a list of whom shall be kept at reception for inspection by appropriate authorities; OR
 - f) Persons taking full table meals, a list of whom are held at reception for inspection by relevant authorities.
17. No striptease, no nudity and all persons on the premises to be decently attired.
18. A Close Circuit Television system shall be installed, maintained and operated correctly as specified by a Metropolitan Police Crime Prevention Officer. The tapes from the system to be retained for a period of 28 days.
19. No payment to be made by or on behalf of the licensee for bringing customers to the premises.
20. There shall be no gaming on the premises other than by machines authorised by Part III (Section 34) of the Gaming Act 1968, or by the Licensing Justices in accordance with Section 6 of the Gaming Act 1968.
21. No persons under 18 years of age to be permitted on the premises during permitted hours except by prior written notice to the police.
22. The maximum number of persons to be present in the licensed premises on each floor shall not exceed the number specified from time to time by the proper officer of the LFCDA. Currently Basement 565 and 30 staff; Balcony 150 and 25 staff.

Conditions which reproduce the effect of any restriction imposed on the use of the premises by specified enactments

Conditions related to the Sale of Alcohol

23. (a) Subject to the following paragraphs, the permitted hours on weekdays shall commence at 10.00 and extend until 03.00 on the morning following, except that -
- (i) the permitted hours shall end at 00.00 midnight on any day on which music and dancing is not provided after midnight; and
 - (ii) on any day that music and dancing end between 00.00 midnight and 03.00, the permitted hours shall end when the music and dancing end;
- (b) In relation to the morning on which summer time begins, paragraph (a) of this condition shall have effect-
- (i) with the substitution of references to 04.00 for references to 03.00.
- (c) Except on Sundays immediately before bank holidays (apart from Easter Sunday), the permitted hours on Sundays shall extend until 00.30 on the morning following, except that-
- (i) the permitted hours shall end at 00.00 midnight on any Sunday on which music and dancing is not provided after midnight;

- (ii) where music and dancing end between 00.00 midnight on any Sunday and 00.30, the permitted hours on that Sunday shall end when the music and dancing end.
- (d) On Sundays immediately before bank holidays (other than Easter Sunday), the permitted hours shall extend until 03.00 on the morning following, except that-
 - (i) the permitted hours shall end at 00.00 midnight on any Sunday on which music and dancing is not provided after 00.00 midnight;
 - (ii) where music and dancing end between 00.00 midnight on any Sunday and 03.00, the permitted hours on that Sunday shall end when the music and dancing end.
- (e) The sale of alcohol must be ancillary to the use of the premises for music and dancing and substantial refreshment.
- (f) The permitted hours on New Year's Eve will extend to the start of permitted hours on the following day, or if there are no permitted hours on 1 January, to 00.00 on New Year's Eve.

NOTE - The above restrictions do not prohibit:

- (a) during the first thirty minutes after the above hours the consumption of the alcohol on the premises;
- (b) during the first twenty minutes after the above hours, the taking of the alcohol from the premises unless the alcohol is supplied or taken in an open vessel;
- (c) the sale or supply of alcohol to or the consumption of alcohol by any person residing in the licensed premises;
- (d) the ordering of alcohol to be consumed off the premises, or the despatch by the vendor of the alcohol so ordered;
- (e) the sale of alcohol to a trader or registered club for the purposes of the trade or club;
- (f) the sale or supply of alcohol to any canteen or mess, being a canteen in which the sale or supply of alcohol is carried out under the authority of the Secretary of State or an authorised mess of members of her Majesty's naval, military or air forces;
- (g) the taking of alcohol from the premises by a person residing there;
- (h) the supply of alcohol for consumption on the premises to any private friends of a person residing there who are bona fide entertained by him at his own expense, or the consumption of alcohol by persons so supplied;
- (i) the supply of alcohol for consumption on the premises to persons employed there for the purposes of the business carried on by the holder of the licence, or the consumption of liquor so supplied, if the liquor is supplied at the expense of their employer or of the person carrying on or in charge of the business on the premises.

In this condition, any reference to a person residing in the premises shall be construed as including a person not residing there but carrying on or in charge of the business on the premises.

- 24. If any entertainment is provided for children or if an entertainment is provided at which the majority of persons attending are children, then, if the number of children attending the entertainment exceeds 100, it shall be the duty of the holder of the premises licence (or the holder of the club premises certificate):
 - (a) to station and keep stationed wherever necessary a sufficient number of adult attendants, properly instructed as to their duties, to prevent more children or other persons being admitted to the building, or to any part thereof, than the building or part can properly accommodate,
 - (b) to control the movement of the children and other persons admitted while entering and leaving the building or any part thereof, and
 - (c) to take all other reasonable precautions for the safety of the children.
- 25. The terminal hour for late night refreshment on New Year's Eve is extended to 05:00 on New Year's Day.

Annex 2 – Conditions consistent with the operating Schedule

26. In the event that a serious assault is committed on the premises (or appears to have been committed) the management will immediately ensure that:
- (a) The Police (and where appropriate, the London Ambulance Service) are called without delay, using emergency telephone number 999;
 - (b) All measures that are reasonably practicable are taken to apprehend any suspects pending the arrival of the Police;
 - (c) As is reasonably practicable, the crime scene is preserved so as to enable a full forensic investigation to be carried out by the Police; and
 - (d) Such other measures are taken (as appropriate) to fully protect the safety of all persons present on the premises.

Annex 3 – Conditions attached after a hearing by the licensing authority

27. When a customer chooses to pay by credit card he/she will be presented with an itemised bill upon final payment showing details of all drink and food purchased.

Annex 4 – Plans

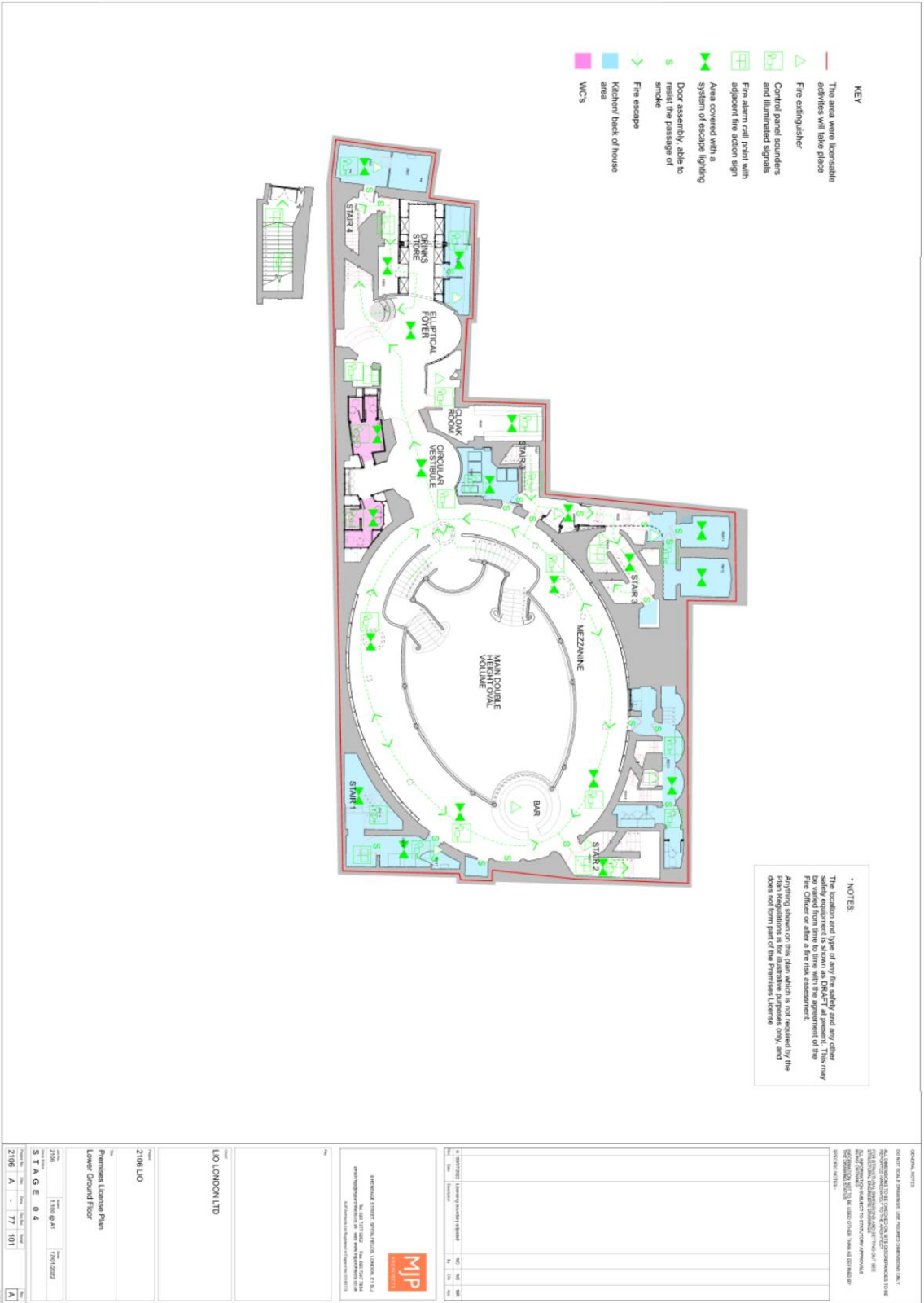

- KEY**
- The area were licensable activities will take place
 - △ Fire extinguisher
 - Fire alarm call point with control panel sounders and illuminated signals
 - Fire alarm call point with sounder and illuminated signals adjacent the exit sign
 - Area covered with a system of escape lighting
 - Door assembly, able to be opened from the passage of smoke
 - Fire escape
 - Kitchen/ back of house area
 - WCs

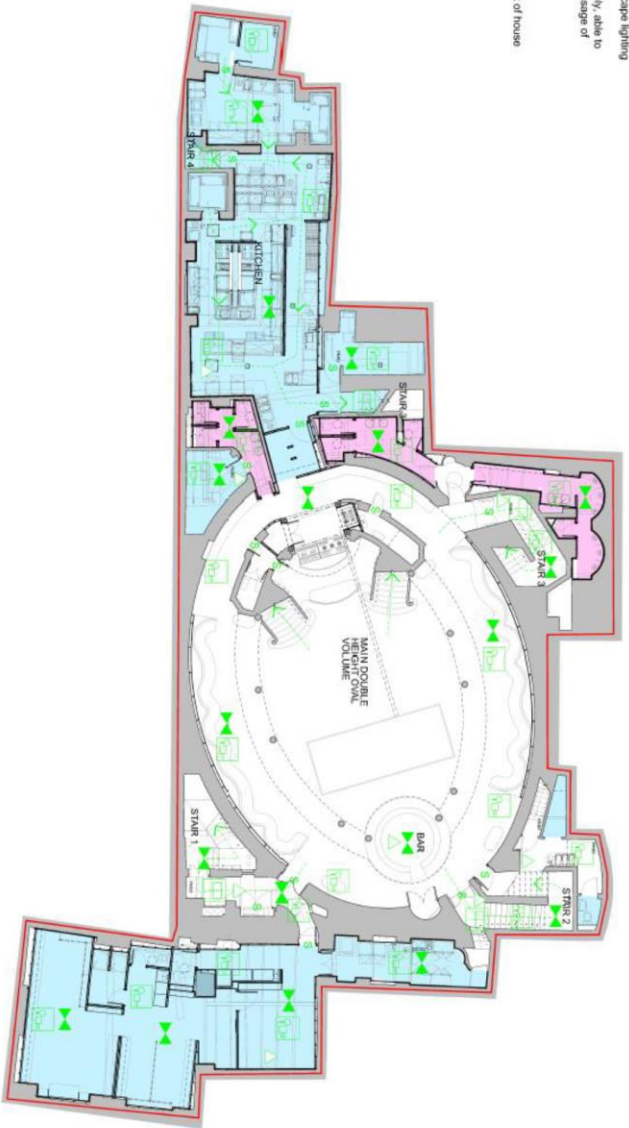

NOTES

The location and type of any fire safety and any other measures shown on this plan may be varied from time to time with the agreement of the Fire Officer or after a fire risk assessment.

Anything shown on this plan which is not required by the Fire Regulations is for illustrative purposes only, and does not form part of the Premises License.

GENERAL NOTES

01. THE LOCAL AUTHORITY HAS REVIEWED THIS PLAN AND IS SATISFIED THAT THE PREMISES COMPLY WITH THE REQUIREMENTS OF THE FIRE REGULATIONS 2006 AND THE FIRE ALARMS AND EMERGENCY SERVICES ACT 1981.

02. THE LOCAL AUTHORITY HAS REVIEWED THIS PLAN AND IS SATISFIED THAT THE PREMISES COMPLY WITH THE REQUIREMENTS OF THE FIRE REGULATIONS 2006 AND THE FIRE ALARMS AND EMERGENCY SERVICES ACT 1981.

03. THE LOCAL AUTHORITY HAS REVIEWED THIS PLAN AND IS SATISFIED THAT THE PREMISES COMPLY WITH THE REQUIREMENTS OF THE FIRE REGULATIONS 2006 AND THE FIRE ALARMS AND EMERGENCY SERVICES ACT 1981.

NO.	DESCRIPTION	DATE	BY
1	ISSUED FOR COMMENT	17/07/2022	MIP
2	REVISED PLAN	17/07/2022	MIP
3	APPROVED FOR LICENSING	17/07/2022	MIP

MIP

PREMISES LICENSING: FIRE SAFETY AND EMERGENCY SERVICES

17/07/2022

2106 LIO

2106 LIO

Premises License Plan

Statement

17/07/2022

STAGE 04

2106 A - 77 100



City of Westminster
64 Victoria Street, London, SW1E 6QP

Schedule 12
Part B

WARD: St James's
UPRN: 010033579206

Premises licence
summary

Regulation 33, 34

Premises licence number:

23/00905/LIPVM

Part 1 – Premises details

Postal address of premises:

Lio London
Basement and Lower Ground Floor
3-4 Coventry Street
London
W1D 6BL

Telephone Number: 0207 734 7700

Where the licence is time limited, the dates:

Not applicable

Licensable activities authorised by the licence:

Performance of Dance
Performance of Live Music
Playing of Recorded Music
Anything of a similar description to Live Music, Recorded Music or Performance of Dance
Late Night Refreshment
Private Entertainment consisting of dancing, music or other entertainment of a like kind for consideration and with a view to profit
Sale by Retail of Alcohol

The times the licence authorises the carrying out of licensable activities:

Performance of Dance

Monday to Sunday: 09:00 to 06:00

Performance of Live Music

Monday to Sunday: 09:00 to 06:00

Playing of Recorded Music

Unrestricted

Anything of a similar description to Live Music, Recorded Music or Performance of Dance

Monday to Sunday: 09:00 to 06:00

Late Night Refreshment

Monday to Sunday: 23:00 to 06:00

Private Entertainment consisting of dancing, music or other entertainment of a like kind for consideration and with a view to profit Unrestricted

Sale by Retail of Alcohol

Monday to Saturday: 10:00 to 03:00
Sunday: 12:00 to 00:30
Sundays before Bank Holidays: 12:00 to 03:00 (Other than Easter Sunday)

For times authorised for New Year see conditions at Annex 1

The opening hours of the premises:

Monday to Sunday: 09:00 to 06:00

Where the licence authorises supplies of alcohol, whether these are on and/or off supplies:

Alcohol is supplied for consumption both on and off the Premises.

Name and (registered) address of holder of premises licence:

Lio London Ltd
The Courtyard
14A Sydenham Road
Croydon
CR0 2EE

Registered number of holder, for example company number, charity number (where applicable)

11551613

Name of designated premises supervisor where the premises licence authorises for the supply of alcohol:

Name: Aaron Sinkia

State whether access to the premises by children is restricted or prohibited:

Prohibited

Date: 07 March 2023

This licence has been authorised by Emanuela Meloyan on behalf of the Director - Public Protection and Licensing.

Applicant Supporting Documents

Appendix 2

None

Licence & Appeal History

Application	Details of Application	Date Determined	Decision
05/06541/LIPCV	Conversion	15.09.2005	Granted by Licensing Sub Committee
12/05860/LIPVM	Minor variation – Change of layout (relocation of stage area)	23.07.2012	Granted under delegated authority
14/02765/LIPVM	Minor variation – Addition of condition	16.04.2014	Granted under delegated authority
14/08607/LIPVM	Minor variation – Addition of condition	24.10.2014	Granted under delegated authority
18/02164/LIPDPS	DPS variation	10.04.2018	Granted under delegated authority
19/07460/LIPDPS	DPS variation	15.07.2019	Granted under delegated authority
19/07587/LIPDPS	DPS variation	15.07.2019	Granted under delegated authority
20/11921/LIPT	Transfer - Maxwell's Restaurants Limited to Raymond Estates Ltd	08.01.2021	Granted under delegated authority
20/11986/LIPN	New premises Licence (Shadow licence)	21.01.2021	Granted under delegated authority
21/02929/LIPT	Transfer - Raymond Estates Ltd to Lio London Ltd	16.04.2021	Granted under delegated authority
22/08698/LIPVM	Minor variation – Change of layout (general refurbishment)	06.10.2022	Granted under delegated authority
23/00905/LIPVM	Minor variation – removal of condition 26	27.02.2023	Granted under delegated authority

There is no appeal history

Temporary Event Notices	Date of Event	Activities/Hours	Decision
23/00761/LITENP	19.02.2023 to 20.02.2023	Regulated entertainment, late night refreshment and Supply of Alcohol – 18:00 to 03:00	Event permitted
23/01026/LITENP	18.03.2021 to 19.03.2021	Supply of Alcohol – 03:00 to 04:00	Event permitted

CONDITIONS CONSISTENT WITH THE OPERATING SCHEDULE AND CONDITIONS PROPOSED BY A PARTY TO THE HEARING

When determining an application for a new premises licence under the provisions of the Licensing Act 2003, the licensing authority must, unless it decides to reject the application, grant the licence subject to the conditions which are indicated as mandatory in this schedule.

At a hearing the licensing authority may, in addition, and having regard to any representations received, grant the licence subject to such conditions which are consistent with the operating schedule submitted by the applicant as part of their application, or alter or omit these conditions, or add any new condition to such extent as the licensing authority considers appropriate for the promotion of the licensing objectives.

This schedule lists those conditions which are consistent with the operating schedule, or proposed as appropriate for the promotion of the licensing objectives by a responsible authority or an interested party as indicated. These conditions have not been submitted by the licensing service but reflect the positions of the applicant, responsible authority or interested party and have not necessarily been agreed

Conditions: On Current Licence -

Mandatory:

1. No supply of alcohol may be made at a time when there is no designated premises supervisor in respect of this licence.
2. No supply of alcohol may be made at a time when the designated premises supervisor does not hold a personal licence or the personal licence is suspended.
3. Every supply of alcohol under this licence must be made or authorised by a person who holds a personal licence.
4.
 - (1) The responsible person must ensure that staff on relevant premises do not carry out, arrange or participate in any irresponsible promotions in relation to the premises.
 - (2) In this paragraph, an irresponsible promotion means any one or more of the following activities, or substantially similar activities, carried on for the purpose of encouraging the sale or supply of alcohol for consumption on the premises—
 - (a) games or other activities which require or encourage, or are designed to require or encourage, individuals to;
 - (i) drink a quantity of alcohol within a time limit (other than to drink alcohol sold or supplied on the premises before the cessation of the period in which the responsible person is authorised to sell or supply alcohol), or
 - (ii) drink as much alcohol as possible (whether within a time limit or otherwise);
 - (b) provision of unlimited or unspecified quantities of alcohol free or for a fixed or discounted fee to the public or to a group defined by a particular characteristic in a manner which carries a significant risk of undermining a licensing objective;

- (c) provision of free or discounted alcohol or any other thing as a prize to encourage or reward the purchase and consumption of alcohol over a period of 24 hours or less in a manner which carries a significant risk of undermining a licensing objective;
 - (d) selling or supplying alcohol in association with promotional posters or flyers on, or in the vicinity of, the premises which can reasonably be considered to condone, encourage or glamorise anti-social behaviour or to refer to the effects of drunkenness in any favourable manner;
 - (e) dispensing alcohol directly by one person into the mouth of another (other than where that other person is unable to drink without assistance by reason of a disability).
5. The responsible person must ensure that free potable water is provided on request to customers where it is reasonably available.
6. (1) The premises licence holder or club premises certificate holder must ensure that an age verification policy is adopted in respect of the premises in relation to the sale or supply of alcohol.
- (2) The designated premises supervisor in relation to the premises licence must ensure that the supply of alcohol at the premises is carried on in accordance with the age verification policy.
- (3) The policy must require individuals who appear to the responsible person to be under 18 years of age (or such older age as may be specified in the policy) to produce on request, before being served alcohol, identification bearing their photograph, date of birth and either—
- (a) a holographic mark, or
 - (b) an ultraviolet feature.
7. The responsible person must ensure that—
- (a) where any of the following alcoholic drinks is sold or supplied for consumption on the premises (other than alcoholic drinks sold or supplied having been made up in advance ready for sale or supply in a securely closed container) it is available to customers in the following measures—
 - (i) beer or cider: ½ pint;
 - (ii) gin, rum, vodka or whisky: 25 ml or 35 ml; and
 - (iii) still wine in a glass: 125 ml;
 - (b) these measures are displayed in a menu, price list or other printed material which is available to customers on the premises; and
 - (c) where a customer does not in relation to a sale of alcohol specify the quantity of alcohol to be sold, the customer is made aware that these measures are available.

A responsible person in relation to a licensed premises means the holder of the premise licence in respect of the premises, the designated premises supervisor (if any) or any individual aged 18 or over who is authorised by either the licence holder or designated premises supervisor.

For premises with a club premises certificate, any member or officer of the club present on the premises in a capacity that which enables him to prevent the supply of alcohol.

8(i) A relevant person shall ensure that no alcohol is sold or supplied for consumption on or off the premises for a price which is less than the permitted price.

8(ii) For the purposes of the condition set out in paragraph 8(i) above -

(a) "duty" is to be construed in accordance with the Alcoholic Liquor Duties Act 1979;

(b) "permitted price" is the price found by applying the formula -

$$P = D + (D \times V)$$

Where -

(i) P is the permitted price,

(ii) D is the amount of duty chargeable in relation to the alcohol as if the duty were charged on the date of the sale or supply of the alcohol, and

(iii) V is the rate of value added tax chargeable in relation to the alcohol as if the value added tax were charged on the date of the sale or supply of the alcohol;

(c) "relevant person" means, in relation to premises in respect of which there is in force a premises licence -

(i) the holder of the premises licence,

(ii) the designated premises supervisor (if any) in respect of such a licence, or

(iii) the personal licence holder who makes or authorises a supply of alcohol under such a licence;

(d) "relevant person" means, in relation to premises in respect of which there is in force a club premises certificate, any member or officer of the club present on the premises in a capacity which enables the member or officer to prevent the supply in question; and

(e) "value added tax" means value added tax charged in accordance with the Value Added Tax Act 1994.

8(iii). Where the permitted price given by Paragraph 8(ii)(b) above would (apart from this paragraph) not be a whole number of pennies, the price given by that sub-paragraph shall be taken to be the price actually given by that sub-paragraph rounded up to the nearest penny.

8(iv). (1) Sub-paragraph 8(iv)(2) below applies where the permitted price given by Paragraph 8(ii)(b) above on a day ("the first day") would be different from the permitted price on the next day ("the second day") as a result of a change to the rate of duty or value added tax.

(2) The permitted price which would apply on the first day applies to sales or supplies of alcohol which take place before the expiry of the period of 14 days beginning on the second day.

Conditions reproducing the effect of conditions subject to which the relevant existing licences have effect.

Conditions relating to regulated entertainment:

9. This licence is subject to all the former Rules of Management for Places of Public Entertainment licensed by Westminster City Council, in force from 4 September 1998 and incorporating amendments agreed by the Council on 25 October 1999, 30 June 2000, 16 January 2001 and 1 October 2001.

The applicant is seeking to remove condition 9

10. Notwithstanding the provisions of Rule of Management No. 6 the premises may remain open for the purposes of this licence from 23:00 on each of the days Sunday to Saturday to 06:00 on the day following.
11. On New Year's Eve the premises can remain open for the purpose of providing regulated entertainment from the time when the provision of regulated entertainment must otherwise cease on New Year's Eve to the time when regulated entertainment can commence on New Year's Day (or until midnight on New Year's Eve where no regulated entertainment takes place on New Year's Day).
12. An attendant shall be stationed in the vicinity of the cloakroom during the whole time that it is in use.
13. Seven days notice shall be given to the Council when a live band is booked for which the primary purpose is NOT to provide music for dancing.
14. The number of persons accommodated (excluding staff) shall not exceed: Balcony - 150, Basement - 565.

Conditions for Sale of Alcohol

15. Substantial food and suitable beverages other than intoxicating liquor (including drinking water) shall be available during the whole of the permitted hours in all parts of the premises where intoxicating liquor is sold or supplied.
16. On any evening where the premises or part of the premises are open for music, dancing or entertainment and a Section 77 Special Hours Certificate is in operation, intoxicating liquor may not be sold or supplied to persons admitted to the premises after 11pm other than to:
 - a) Persons who have paid a minimum admission fee of at least £5 Monday to Thursday, and £7 Friday and Saturday (these fees to be reviewed and set by the Licensing Justices at their triennial renewal sessions) for music, dancing and entertainment (not to be credited against consumables); OR
 - b) Persons who have paid a minimum annual admission fee of at least £150 payable in advance for music, dancing and entertainment (not to be credited against consumables). Such person may bring with them up to 4 guests. A list of all persons who have paid an annual admission fee will be held at reception for inspection by the relevant authority; OR
 - c) Any person attending a private function at the premises, details of the type of function, host and a list of persons attending having been provided to the police at least 24 hours previously; OR
 - d) Artistes and persons employed on the premises; OR e) Bona fide guests of the proprietor (not exceeding 10% of the total capacity for the premises as specified

in the Public Entertainment Licence for the premises), a list of whom shall be kept at reception for inspection by appropriate authorities; OR

- f) Persons taking full table meals, a list of whom are held at reception for inspection by relevant authorities.
- 17. No striptease, no nudity and all persons on the premises to be decently attired.
- 18. A Close Circuit Television system shall be installed, maintained and operated correctly as specified by a Metropolitan Police Crime Prevention Officer. The tapes from the system to be retained for a period of 28 days.

The applicant is seeking to remove condition 18

- 19. No payment to be made by or on behalf of the licensee for bringing customers to the premises.
- 20. There shall be no gaming on the premises other than by machines authorised by Part III (Section 34) of the Gaming Act 1968, or by the Licensing Justices in accordance with Section 6 of the Gaming Act 1968.
- 21. No persons under 18 years of age to be permitted on the premises during permitted hours except by prior written notice to the police.
- 22. The maximum number of persons to be present in the licensed premises on each floor shall not exceed the number specified from time to time by the proper officer of the LFCDA. Currently Basement 565 and 30 staff; Balcony 150 and 25 staff.

Conditions which reproduce the effect of any restriction imposed on the use of the premises by specified enactments

Conditions related to the Sale of Alcohol

- 23. (a) Subject to the following paragraphs, the permitted hours on weekdays shall commence at 10.00 and extend until 03.00 on the morning following, except that
 -
 - (i) the permitted hours shall end at 00.00 midnight on any day on which music and dancing is not provided after midnight; and
 - (ii) on any day that music and dancing end between 00.00 midnight and 03.00, the permitted hours shall end when the music and dancing end;
- (b) In relation to the morning on which summer time begins, paragraph (a) of this condition shall have effect-
 - (i) with the substitution of references to 04.00 for references to 03.00.
- (c) Except on Sundays immediately before bank holidays (apart from Easter Sunday), the permitted hours on Sundays shall extend until 00.30 on the morning following, except that-
 - (i) the permitted hours shall end at 00.00 midnight on any Sunday on which music and dancing is not provided after midnight;
 - (ii) where music and dancing end between 00.00 midnight on any Sunday and 00.30, the permitted hours on that Sunday shall end when the music and dancing end.

- (d) On Sundays immediately before bank holidays (other than Easter Sunday), the permitted hours shall extend until 03.00 on the morning following, except that-
 - (i) the permitted hours shall end at 00.00 midnight on any Sunday on which music and dancing is not provided after 00.00 midnight;
 - (ii) where music and dancing end between 00.00 midnight on any Sunday and 03.00, the permitted hours on that Sunday shall end when the music and dancing end.
- (e) The sale of alcohol must be ancillary to the use of the premises for music and dancing and substantial refreshment.
- (f) The permitted hours on New Year's Eve will extend to the start of permitted hours on the following day, or if there are no permitted hours on 1 January, to 00.00 on New Year's Eve.

NOTE - The above restrictions do not prohibit:

- (a) during the first thirty minutes after the above hours the consumption of the alcohol on the premises;
- (b) during the first twenty minutes after the above hours, the taking of the alcohol from the premises unless the alcohol is supplied or taken in an open vessel;
- (c) the sale or supply of alcohol to or the consumption of alcohol by any person residing in the licensed premises;
- (d) the ordering of alcohol to be consumed off the premises, or the despatch by the vendor of the alcohol so ordered;
- (e) the sale of alcohol to a trader or registered club for the purposes of the trade or club;
- (f) the sale or supply of alcohol to any canteen or mess, being a canteen in which the sale or supply of alcohol is carried out under the authority of the Secretary of State or an authorised mess of members of her Majesty's naval, military or air forces;
- (g) the taking of alcohol from the premises by a person residing there;
- (h) the supply of alcohol for consumption on the premises to any private friends of a person residing there who are bona fide entertained by him at his own expense, or the consumption of alcohol by persons so supplied;
- (i) the supply of alcohol for consumption on the premises to persons employed there for the purposes of the business carried on by the holder of the licence, or the consumption of liquor so supplied, if the liquor is supplied at the expense of their employer or of the person carrying on or in charge of the business on the premises.

In this condition, any reference to a person residing in the premises shall be construed as including a person not residing there but carrying on or in charge of the business on the premises.

24. If any entertainment is provided for children or if an entertainment is provided at which the majority of persons attending are children, then, if the number of children attending the entertainment exceeds 100, it shall be the duty of the holder of the premises licence (or the holder of the club premises certificate):
- (a) to station and keep stationed wherever necessary a sufficient number of adult attendants, properly instructed as to their duties, to prevent more children or other persons being admitted to the building, or to any part thereof, than the building or part can properly accommodate,

- (b) to control the movement of the children and other persons admitted while entering and leaving the building or any part thereof, and
 - (c) to take all other reasonable precautions for the safety of the children.
25. The terminal hour for late night refreshment on New Year's Eve is extended to 05:00 on New Year's Day.

Annex 2 - Conditions consistent with the operating Schedule

26. In the event that a serious assault is committed on the premises (or appears to have been committed) the management will immediately ensure that:
- (a) The Police (and where appropriate, the London Ambulance Service) are called without delay, using emergency telephone number 999;
 - (b) All measures that are reasonably practicable are taken to apprehend any suspects pending the arrival of the Police;
 - (c) As is reasonably practicable, the crime scene is preserved so as to enable a full forensic investigation to be carried out by the Police; and
 - (d) Such other measures are taken (as appropriate) to fully protect the safety of all persons present on the premises.

Annex 3 - Conditions attached after a hearing by the licensing authority

27. When a customer chooses to pay by credit card he/she will be presented with an itemised bill upon final payment showing details of all drink and food purchased.

Conditions to be added to the premises licence

28. The premises shall install and maintain a comprehensive CCTV system as per the minimum requirements of the Westminster Police Licensing Team.
- (b) All entry and exit points will be covered enabling frontal identification of every person entering in any light condition.
 - (c) The CCTV system shall continually record whilst the premises is open for licensable activities and during all times when customers remain on the premises and will include the external area immediately outside the premises entrance.
 - (d) All recordings shall be stored for a minimum period of 31 days with date and time stamping.
 - (e) Viewing of recordings shall be made available immediately upon the request of Police or authorised officer throughout the entire 31-day period.
29. A staff member from the premises who is conversant with the operation of the CCTV system shall be on the premises at all times when the premises is open. This staff member must be able to provide a Police or authorised council officer copies of recent CCTV images or data with the absolute minimum of delay when requested.
30. An incident log shall be kept at the premises, and made available on request to an authorised officer of the City Council or the Police. It must be completed within 24 hours of the incident and will record the following:
- (a) all crimes reported to the venue
 - (b) all ejections of patrons
 - (c) any complaints received concerning crime and disorder
 - (d) any incidents of disorder
 - (e) all seizures of drugs or offensive weapons
 - (f) any faults in the CCTV system, searching equipment or scanning equipment
 - (g) any refusal of the sale of alcohol
 - (h) any visit by a relevant authority or emergency service.

31. A copy of the premises' dispersal policy shall be made readily available at the premises for inspection by a police officer and/or an authorised officer of Westminster City Council.
32. A Challenge 25 proof of age scheme shall be operated at the premises where the only acceptable forms of identification are recognised photographic identification cards, such as a driving licence, passport or proof of age card with the PASS Hologram.
33. The approved arrangements at the premises, including means of escape provisions, emergency warning equipment, the electrical installation and mechanical equipment, shall at all material times be maintained in good condition and full working order.
34. The means of escape provided for the premises shall be maintained unobstructed, free of trip hazards, be immediately available and clearly identified in accordance with the plans provided.
35. All emergency exit doors shall be available at all material times without the use of a key, code, card or similar means.
36. All emergency doors shall be maintained effectively self closing and not held open other than by an approved device.
37. The edges of the treads of steps and stairways shall be maintained so as to be conspicuous.
38. Curtains and hangings shall be arranged so as not to obstruct emergency safety signs or emergency equipment.
39. After 03:00, Patrons permitted to temporarily leave and then re-enter the premises, e.g. to smoke or make a phone call, shall be limited to **(TBC)** persons at any one time.
40. Patrons permitted to temporarily leave and then re-enter the premises, e.g. to smoke or make a phone call, shall not be permitted to take glass containers with them.
41. The premises licence holder shall ensure that any patrons smoking outside the premises do so in an orderly manner and are properly supervised by staff so as to ensure that there is no public nuisance or obstruction of the public highway.
42. There shall be no new admittance to the premises after 03:00 hours.
43. All members of management will be provided with Welfare and Vulnerability Engagement (WAVE) training to provide those working in the licensed industry with an awareness of vulnerability and their responsibilities towards people visiting their premises. This training is available at: [Welfare and Vulnerability Engagement \(WAVE\) Resources \(nbcc.police.uk\)](http://nbcc.police.uk)

3-4 Coventry Street



03/03/2023, 16:34:42

- Property Mailing List
- Ward Boundaries
- Borough Boundary - Mask
- Borough Boundary - Detailed
- Ward Labels

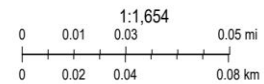

Resident count: 26

Licensed premises within 75m of 3-4 Coventry Street London W1D 6BL				
Licence Number	Trading Name	Address	Premises Type	Time Period
22/09452/LIPDPS	The Rialto Casino Piccadilly	Upper Ground Floor To Third Floor 3-4 Coventry Street London W1D 6BL	Casino or gambling club	Sunday; 12:00 - 12:00 Monday to Saturday; 10:00 - 10:00
20/11986/LIPN	Cafe De Paris (Shadow Licence)	Basement And Lower Ground Floor	Premises Licence - Shadow Licence	Monday to Sunday; 09:00 - 06:00

		3-4 Coventry Street London W1D 6BL		
22/08698/LIPVM	Lio London	Basement And Lower Ground Floor 3-4 Coventry Street London W1D 6BL	Night clubs and discos	Monday; 09:00 - 06:00 Tuesday; 09:00 - 06:00 Wednesday; 09:00 - 06:00 Thursday; 09:00 - 06:00 Friday; 09:00 - 06:00 Saturday; 09:00 - 06:00 Sunday; 09:00 - 06:00
22/01930/LIPDPS	Shake Shack	1 - 2 Coventry Street London W1D 6BH	Food store	Sunday; 10:00 - 02:30 Monday to Saturday; 10:00 - 03:00
16/08990/LIPVM	Shake Shack	1 - 2 Coventry Street London W1D 6BH	Restaurant	Sunday; 23:00 - 02:30 Monday to Saturday; 23:00 - 03:00
21/14481/LIPT	Basement Of 3-5 Wardour Street	3-5 Wardour Street London W1D 6PB	Restaurant	Sunday; 12:00 - 22:30 Monday to Saturday; 12:00 - 23:00
21/05711/LIPN	Layalina	32 Coventry Street London W1D 6BR	Restaurant	Monday to Sunday; 00:00 - 00:00
22/07173/LIPN	Not Recorded	Basement And Ground Floor 7 Wardour Street London W1D 6PE	Restaurant	Monday; 10:30 - 23:30 Tuesday; 10:30 - 23:30 Wednesday; 10:30 - 23:30 Thursday; 10:30 - 23:30 Friday; 10:30 - 23:30 Saturday; 10:30 - 23:30 Sunday; 10:30 - 23:30

22/10452/LIPDPS	Thistle Piccadilly Hotel	39 Coventry Street London W1D 6BZ	Hotel, 4+ star or major chain	Sunday; 12:00 - 23:00 Sunday; 12:00 - 00:00 Monday to Saturday; 10:00 - 23:30 Monday to Saturday; 10:00 - 00:30
23/00615/LIPD	Misato Restaurant	11 Wardour Street London W1D 6PG	Restaurant	Monday to Sunday; 11:00 - 00:00
21/06490/LIPT	Sugar	First Floor And Second Floor 11 Wardour Street London W1D 6PG	Club or institution	Monday; 09:00 - 03:30 Tuesday; 09:00 - 03:30 Wednesday; 09:00 - 03:30 Thursday; 09:00 - 03:30 Friday; 09:00 - 06:00 Saturday; 09:00 - 06:00 Sunday; 09:00 - 23:00 Monday to Thursday; 09:00 - 03:30 Friday to Saturday; 09:00 - 06:00
19/09537/LIPDPS	Waxy O'Connor's	Basement And Ground Floor 14 - 16 Rupert Street London W1D 6DD	Public house or pub restaurant	Sunday; 12:00 - 00:00 Sunday; 12:00 - 23:00 Monday to Thursday; 10:00 - 23:30 Monday to Saturday; 10:00 - 00:30 Friday to Saturday; 10:00 - 00:00 Sundays before Bank Holidays; 12:00 - 00:00
16/10204/LIPV	London Jade Garden	15 Wardour Street London W1D 6PH	Restaurant	Sunday; 12:00 - 23:00 Monday to Thursday; 10:00 - 00:00 Friday to

				Saturday; 10:00 - 00:30
20/03201/LIPN	Orient London	15 Wardour Street London W1D 6PH	Restaurant	Monday; 10:00 - 00:30 Tuesday; 10:00 - 00:30 Wednesday; 10:00 - 00:30 Thursday; 10:00 - 00:30 Friday; 10:00 - 00:30 Saturday; 10:00 - 00:30 Sunday; 12:00 - 00:00
20/02193/LIPRW	Happy Bar & Grill	25-29 Coventry Street London W1D 7AG	Restaurant	Sunday; 12:00 - 00:30 Monday to Saturday; 10:00 - 01:30 Sundays before Bank Holidays; 12:00 - 01:00
17/02769/LIPDPS	The Comedy Store	Ground Floor Right Haymarket House 1A Oxendon Street London SW1Y 4EE	Theatre	Sunday; 09:00 - 01:00 Monday to Saturday; 09:00 - 05:00
22/07383/LIPDPS	Heritage	18 Rupert Street London W1D 6DD	Restaurant	Sunday; 12:00 - 00:00 Monday to Wednesday; 10:00 - 01:00 Thursday to Saturday; 10:00 - 01:30
20/02226/LIPDPS	Morden & Lea	17 Wardour Street London W1D 6PJ	Restaurant	Sunday; 12:00 - 00:00 Monday to Wednesday; 10:00 - 00:30 Thursday to Saturday; 10:00 - 01:30
22/11749/LIPDPS	Prince Of Wales Theatre	31 Coventry Street London W1D 6AS	Theatre	Monday to Sunday; 09:00 - 00:00

22/06997/LIPDPS	W Hotel	W London Leicester Square 10 Wardour Street London W1D 6QF	Hotel, 4+ star or major chain	Monday to Sunday; 00:00 - 00:00
21/13272/LIPDPS	Burger & Lobster	W London Leicester Square 10 Wardour Street London W1D 6QF	Not Recorded	Monday to Sunday; 08:00 - 01:00
22/12049/LIPT	Old Town 97	19 Wardour Street London W1D 6PL	Restaurant	Sunday; 12:00 - 04:00 Monday to Saturday; 10:00 - 04:00
06/12381/WCCMAP	Cafe T.P.T.	21 Wardour Street London W1D 6PN	Restaurant	Sunday; 12:00 - 01:00 Monday to Saturday; 10:00 - 01:00
19/03860/LIPDPS	Four Seasons	23 Wardour Street London W1D 6PW	Restaurant	Sunday; 12:00 - 05:00 Monday to Saturday; 10:00 - 05:00
22/11676/LIPDPS	The Piano Works - West End	Clareville House 47 Whitcomb Street London WC2H 7DH	Night clubs and discos	Wednesday; 09:00 - 03:30 Sunday; 12:00 - 00:00 Monday to Tuesday; 09:00 - 01:30 Thursday to Saturday; 09:00 - 02:30
18/09315/LIPN	Studio 88 (Shadow Licence)	Sub- Basement, Basement Part And Ground Floor Part Clareville House 47 Whitcomb Street London WC2H 7DH	Premises Licence - Shadow Licence	Wednesday; 09:00 - 02:30 Sunday; 12:00 - 00:00 Monday to Tuesday; 09:00 - 01:30 Thursday to Saturday; 09:00 - 03:30